

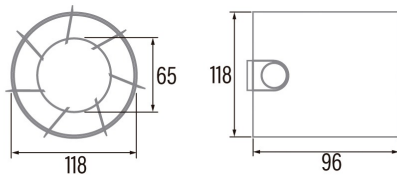

MT-125

Cod. **00720000**

EAN **8422248920520**



GENERAL INFORMATION

| | |
|-----------|---------------|
| EAN/UPC | 8422248920520 |
| Subfamily | In Line |

General features

| | |
|--|----------------|
| Motor type | AC/SHADED POLE |
| Motor model | SP5820 |
| Motor power (W) | 20 |
| Lighting technology | N/A |
| Light quantity | N/A |
| Filter type | N/A |
| Number of layers | N/A |
| Control description | N/A |
| Power levels | N/A |
| Timer | - |
| Hygro timer | - |
| Electronic filter saturation indicator | - |
| Dimmable lighting | - |

Installation

| | |
|---------------------------|------|
| Width (mm) | 118 |
| Height (mm) | 118 |
| Depth (mm) | 96 |
| Total minimum height (mm) | 2300 |
| Outlet diameter (mm) | 118 |
| Maximum pressure (Pa) | 48 |
| Anti-return flap included | - |
| Easy installation system | No |

Power connection

| | |
|---------------------------|----------|
| Nominal voltage (V) | 220-240 |
| Nominal frequency (Hz) | 50/60 |
| Nominal input power (W) | 20 |
| Electric shock protection | Class II |
| Plug type | No plug |

Accessories

| | |
|---------------------------|---------|
| Fixed grill | 1920200 |
| Overpressure relief valve | 1920300 |
| Support | 1991000 |

Power and water connection

| | |
|---------------------------|----------|
| Nominal voltage (V) | 220-240 |
| Nominal frequency (Hz) | 50/60 |
| Nominal input power (W) | 20 |
| Electric shock protection | Class II |
| Plug type | No plug |